

# MORE THAN PET

Wellpac started in October, 2008 with PET bottles & jars, but now **PET** here means more.

## P

**Product**----Range from heavy wall PET jar, PP jar, closure, foaming pump as well PET bottle.

**Pre-audit factory, inline product monitoring and final product inspection.**

**Purchasing**---- We have been sourcing and purchasing variety of relative qualified packaging products to match our own components so as to provide seamless integrated product to our valuable clients. Our engineers and QC team are well trained and experienced to support above processing operate effectively.

**Performance**----We are co-operating with both domestic and foreign brand cosmetic companies.

## E

### **Entrepreneurship**

With our innovative and diligent sprit, growing with our employees and clients as well return to society what we achieve.

### **Efficiency**

We have been striving for high efficiency from the very beginning of founding to enhance speed, profit and success for us and our partners.

### **Equipment**

Wellpac is equipped with injection machines, automatic blowing machines, silk screen printing , pad printing, thermal printing, hot stamp, ultrasonic welding, automatic label application machines and automatic assembling for pumps. We provide injection and blowing mold development.

## T

### **Target**

To be better more than clients expect, grow and success with our clients and our employees.





Injection workshop 注塑车间

Automatic silk screen machine  
自动丝印机



Printing workshop  
(silk screen printing, pad printing,  
thermal printing, hot stamp and ultra  
sonic welding service available)

印刷车间  
可提供丝印、移印、热转印、烫金/银及  
超声波焊接服务



Injection stretch blow molding machine  
ASB一步法拉伸吹塑成型机

Blowing workshop  
吹瓶车间





## One-step heavy wall PET jar 注塑成型厚壁PET罐

1. Competitive price comparing with PETG jar.  
相比PETG罐，成本非常有竞争力。
2. ABS lid with EPE or foam liner.  
配ABS材料盖子及垫片。
3. Sifter with sticker available inside jars for powder product.  
配备带封口膜的筛网，可装粉类产品。

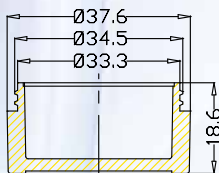

**ZB-35-10**

满口水容量(O.F.C.): 11ml

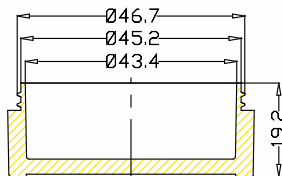

**ZB-47-20**

满口水容量(O.F.C.): 23ml

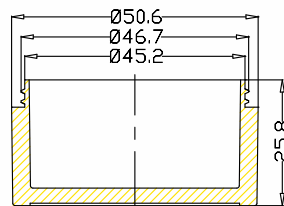

**ZB-47-30**

满口水容量(O.F.C.): 32ml







### One-step heavy wall PET jar 注塑成型厚壁PET罐

1. Competitive price comparing with PETG jar.  
相比PETG罐，成本非常有竞争力。
2. High profile PP lid with EPE liner as well ABS lid available.  
配高身PP盖或常规ABS盖，EPE垫片。

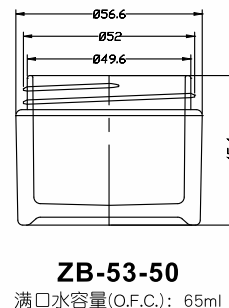
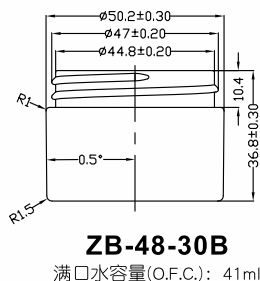
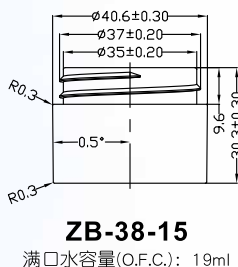
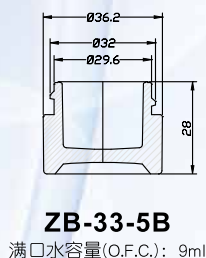
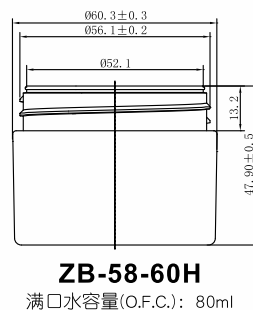
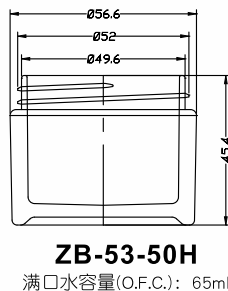
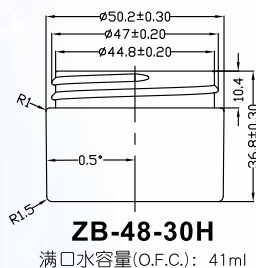
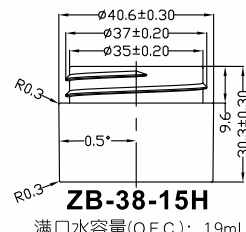



### Two-step blowing PET jar 两步法注拉吹PET罐

Dome PP lid or aluminum shell plus PP lid available as well aluminum lid.  
配圆顶PP盖或套铝盖甚至纯铝盖都可以。

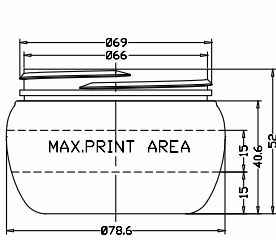

**CB-69-160**

满口水容量(O.F.C.): 197ml

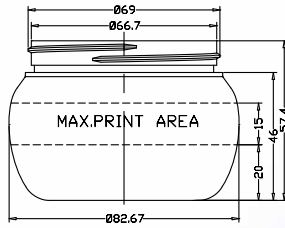

**CB-69-200**

满口水容量(O.F.C.): 236ml

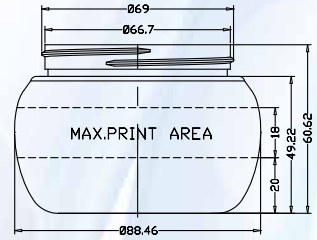

**CB-69-250**

满口水容量(O.F.C.): 275ml

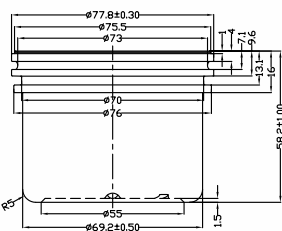

**CB-78-150**

满口水容量(O.F.C.): 188ml

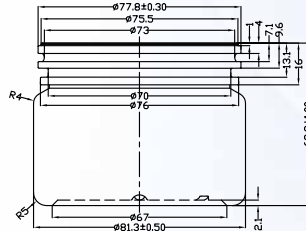

**CB-78-250**

满口水容量(O.F.C.): 260ml

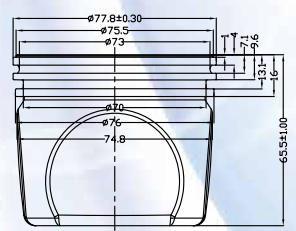

**CB-78-250A**

满口水容量(O.F.C.): 260ml



CB-38-40



CB-47-70



CB-70-250

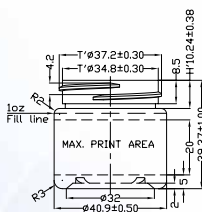

**CB-38-40**

满口水容量(O.F.C.): 40ml

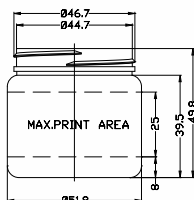

**CB-47-70**

满口水容量(O.F.C.): 87ml

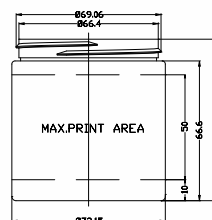

**CB-70-250**

满口水容量(O.F.C.): 290ml



CB-70-120



CB-70-150



CB-70-200

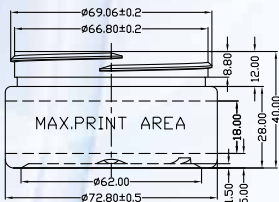

**CB-70-120**

满口水容量(O.F.C.): 140ml

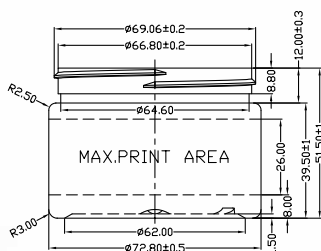

**CB-70-150**

满口水容量(O.F.C.): 188ml

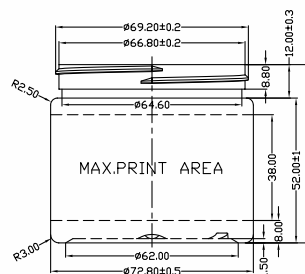

**CB-70-200**

满口水容量(O.F.C.): 235ml



### Two-step blowing PET jar 两步法注拉吹PET罐

1. Cylinder round PP lid or aluminum shell plus PP lid as well aluminum lid.  
配直角圆形PP盖或套铝盖甚至纯铝盖都可以。
2. 35g & 45g weight preform for blowing 89-400 jars for your choice.  
89牙罐子可选择35克或45克胚管吹塑成型。



NY-89-PP



CB-89-200



CB-89-250



CB-89-270



CB-89-300



CB-89-350



CB-89-400

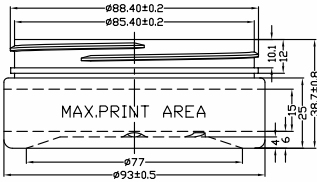

**CB-89-200**

满口水容量(O.F.C.): 218ml

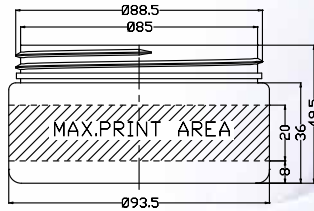

**CB-89-250**

满口水容量(O.F.C.): 290ml

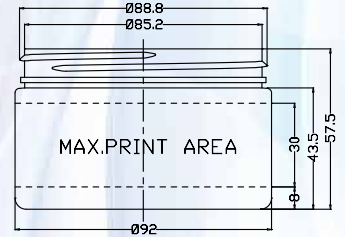

**CB-89-270**

满口水容量(O.F.C.): 308ml

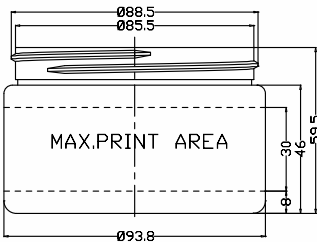

**CB-89-300**

满口水容量(O.F.C.): 338ml

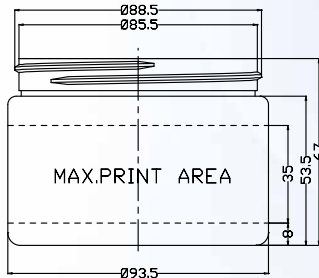

**CB-89-350**

满口水容量(O.F.C.): 397ml

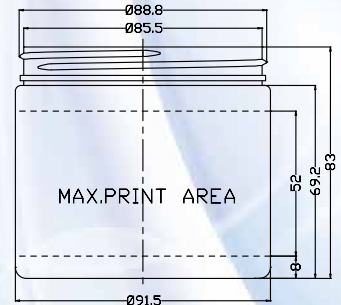

**CB-89-400**

满口水容量(O.F.C.): 480ml



ZB-13-5B

ZB-18-10

ZB-18-10

B-20-30H

### Two-step injection heavy wall PET bottle 两步法注塑成型厚壁PET瓶

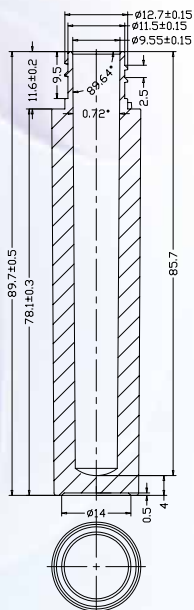

**ZB-13-5B**

满口水容量(O.F.C.): 5ml

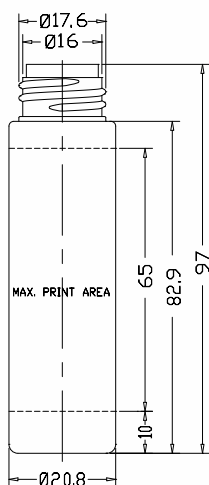

**ZB-18-10**

满口水容量(O.F.C.): 13ml

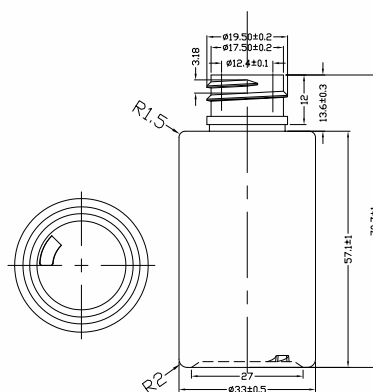

**B-20-30H**

满口水容量(O.F.C.): 32ml



B-20-80H



B-20-60H



C-20-80H



C-20-60H

### Two-step blowing heavy wall high transparent PETE bottle 两步法吹塑厚壁高透明PETE瓶

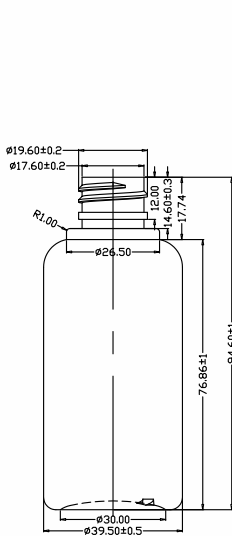

**B-20-80H**

满口水容量(O.F.C.): 87ml

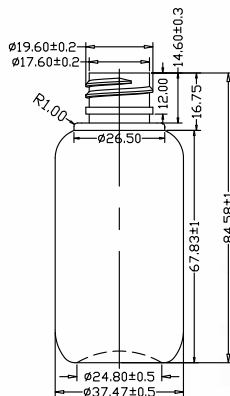

**B-20-60H**

满口水容量(O.F.C.): 65ml

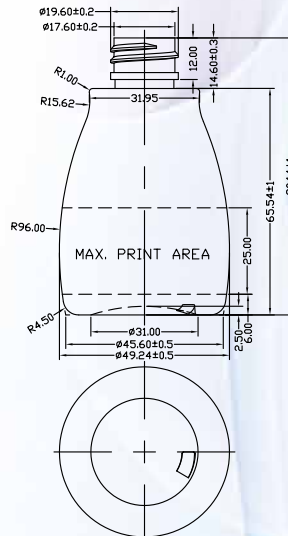

**C-20-80H**

满口水容量(O.F.C.): 95ml

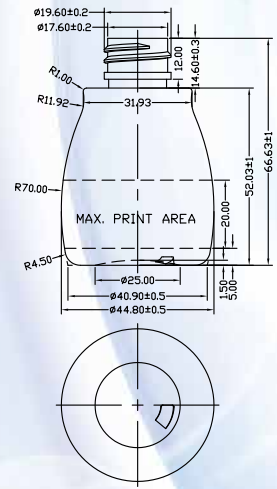

**C-20-60H**

满口水容量(O.F.C.): 66ml



YP-30-30

YP-30-50

YP-30-60

YP-30-100

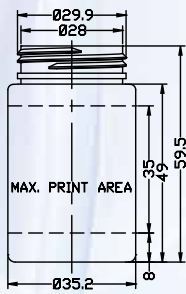

**YP-30-30**

满口水容量(O.F.C.): 44ml

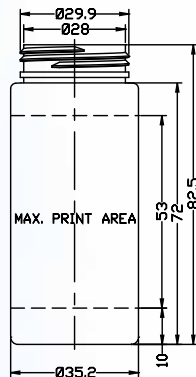

**YP-30-50**

满口水容量(O.F.C.): 67ml

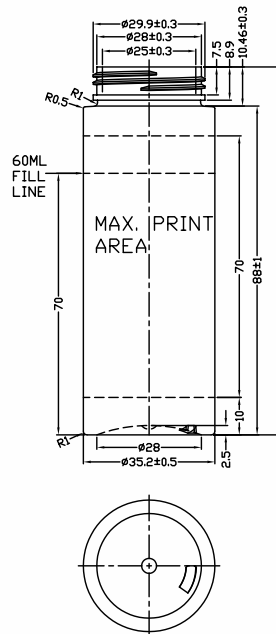

**YP-30-60**

满口水容量(O.F.C.): 82ml

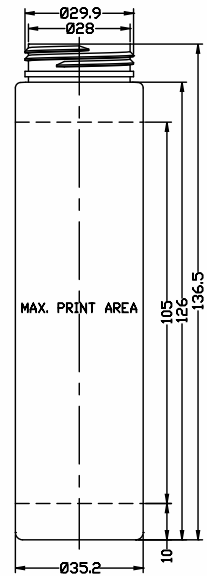

**YP-30-100**

满口水容量(O.F.C.): 114ml

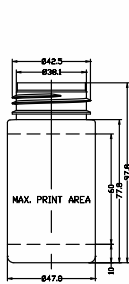

**YP-43-100**

满口水容量(O.F.C.): 140ml

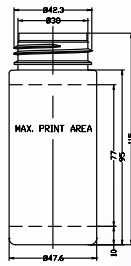

**YP-43-120**

满口水容量(O.F.C.): 170ml

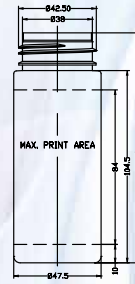

**YP-43-150**

满口水容量(O.F.C.): 189ml

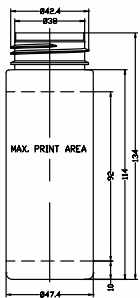

**YP-43-160**

满口水容量(O.F.C.): 200ml

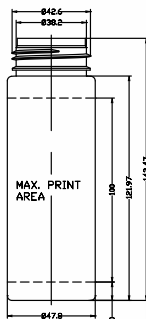

**YP-43-170**

满口水容量(O.F.C.): 220ml

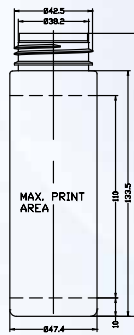

**YP-43-200**

满口水容量(O.F.C.): 235ml

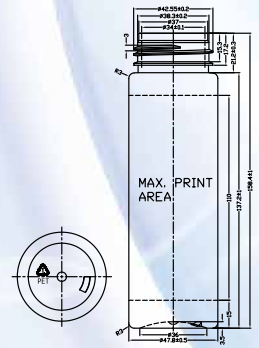

**YP-43-210**

满口水容量(O.F.C.): 248ml





CP-30-50

CP-30-100

YX-40-100

YX-43-150

YP-43-150

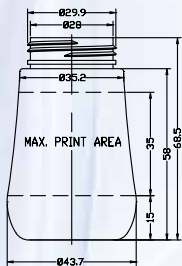

**CP-30-50**

满口水容量(O.F.C.): 66ml

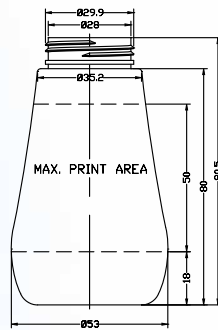

**CP-30-100**

满口水容量(O.F.C.): 120ml

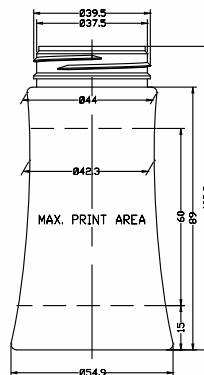

**YX-40-100**

满口水容量(O.F.C.): 136ml

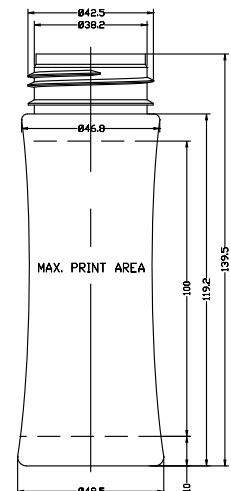

**YX-43-150**

满口水容量(O.F.C.): 184ml





SR-40-250



SR-40-300



SR-40-400

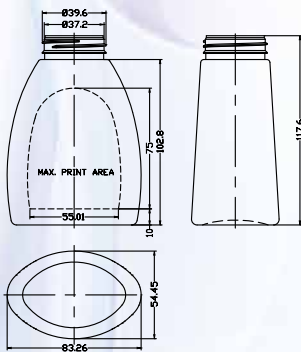

**SR-40-250**

满口水容量(O.F.C.): 280ml

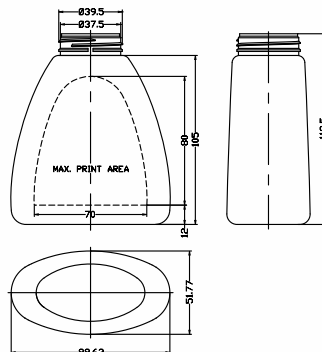

**SR-40-300**

满口水容量(O.F.C.): 332ml

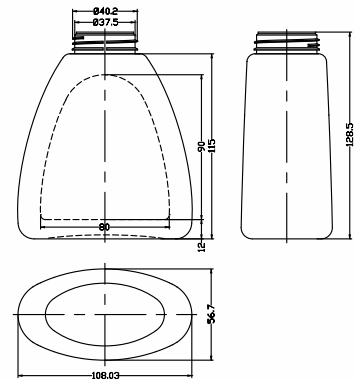

**SR-40-400**

满口水容量(O.F.C.): 440ml



Y-20-100F

Y-20-120F

Y-24-120H

Y-24-150F

Y-24-120J

Y-24-200F

Y-24-250F

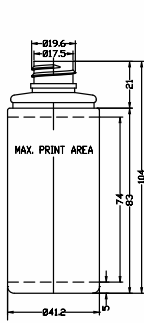

**Y-20-100F**

满口水容量(O.F.C.): 105ml

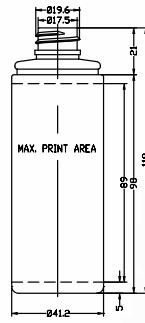

**Y-20-120F**

满口水容量(O.F.C.): 125ml

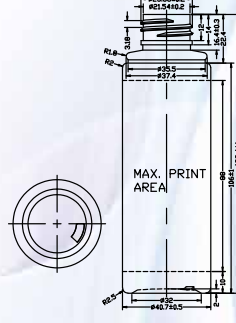

**Y-24-120H**

满口水容量(O.F.C.): 135ml

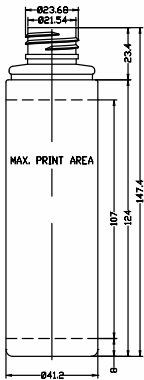

**Y-24-150F**

满口水容量(O.F.C.): 156ml

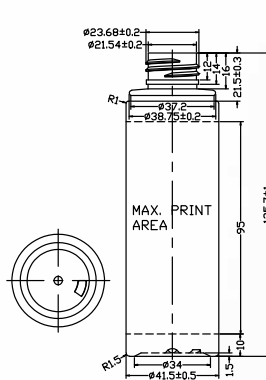

**Y-24-120J**

满口水容量(O.F.C.): 142ml

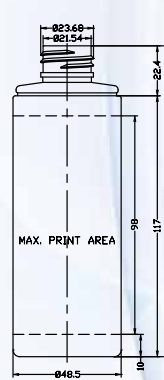

**Y-24-200F**

满口水容量(O.F.C.): 210ml

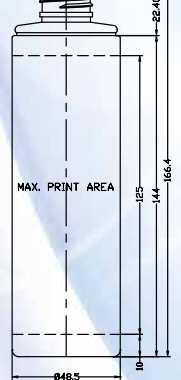

**Y-24-250F**

满口水容量(O.F.C.): 260ml



Neck finish “H” can be adjusted upon different lotion pumps to be used  
 螺牙高度可根据使用的泵头进行调整

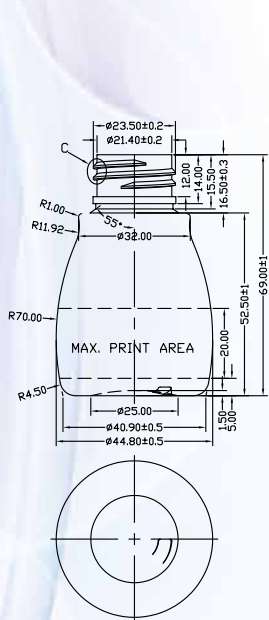

**C-24-60**

满口水容量(O.F.C.): 66ml

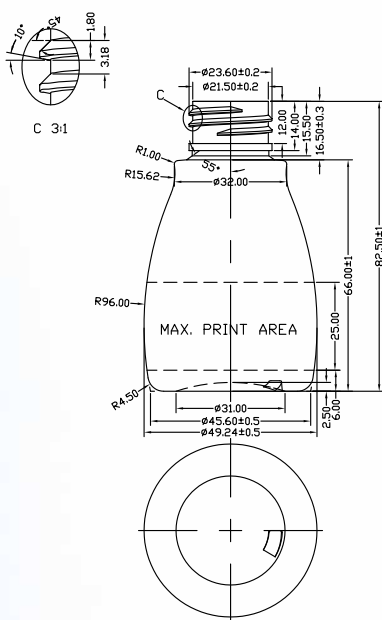

**C-24-80**

满口水容量(O.F.C.): 95ml

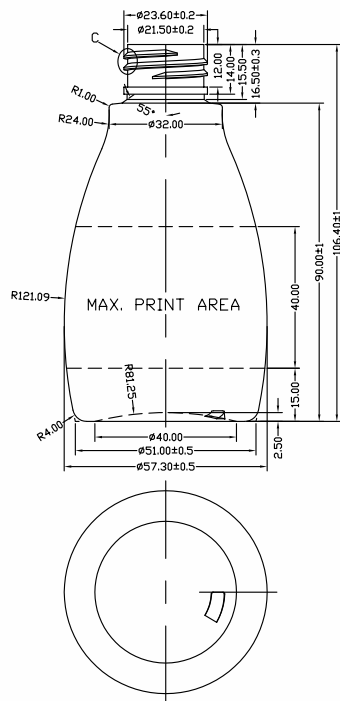

**C-24-150**

满口水容量(O.F.C.): 162ml





Y-32-120



SR-32-90



SR-32-50



Y-24-50C



Y-24-50P



Y-24-100P

1. Nail wash pump and heavy wall PET bottle.  
指甲水泵头及配套的厚壁PET瓶。
2. Dosage: 0.5cc.  
泵出量：0.5cc。
3. Silicon sifter with buffer function.  
内置硅胶缓冲阀。

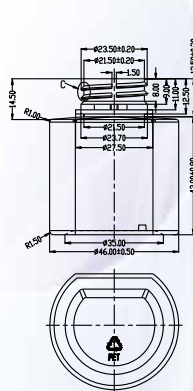

Y-24-50P

满口水容量(O.F.C.): 57ml

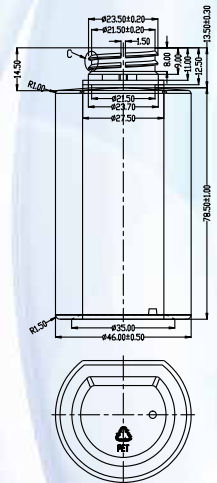

Y-24-100P

满口水容量(O.F.C.): 110ml

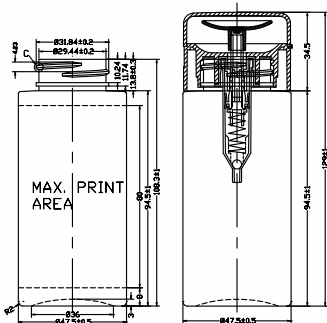

Y-32-120

满口水容量(O.F.C.): 148ml

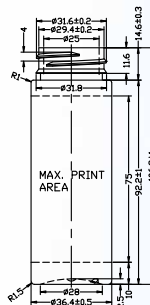

SR-32-90

满口水容量(O.F.C.): 92ml

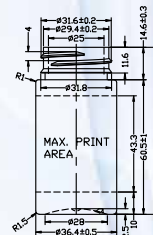

SR-32-50

满口水容量(O.F.C.): 59ml



SR-20-45



SR-20-60A



SR-24-100



SR-24-150A

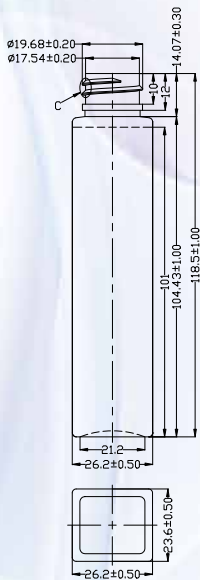

**SR-20-45**

满口水容量(O.F.C.): 50ml

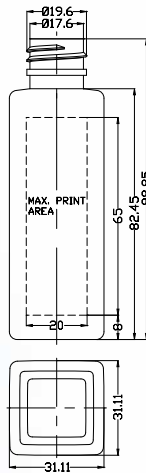

**SR-20-60A**

满口水容量(O.F.C.): 67ml

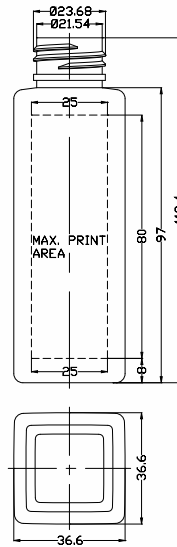

**SR-24-100**

满口水容量(O.F.C.): 110ml

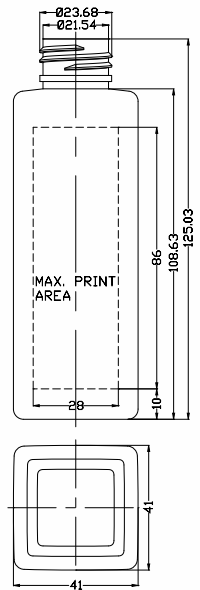

**SR-24-150A**

满口水容量(O.F.C.): 160ml



SR-24-200B

SR-24-250G

SR-24-250F

SR-24-200A

SR-24-150B

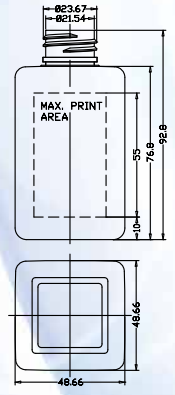
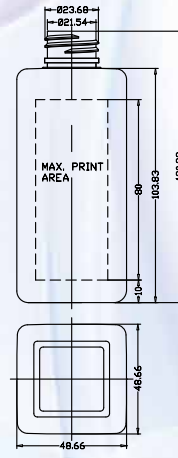
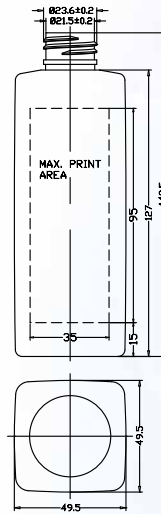
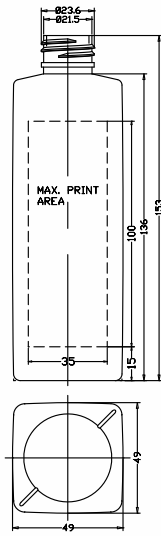
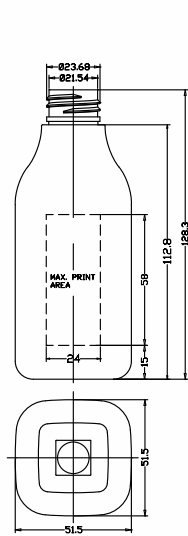

**SR-24-200B**

满口水容量(O.F.C.): 221ml

**SR-24-250G**

满口水容量(O.F.C.): 280ml

**SR-24-250F**

满口水容量(O.F.C.): 263ml

**SR-24-200A**

满口水容量(O.F.C.): 225ml

**SR-24-150B**

满口水容量(O.F.C.): 161ml





SR-24-150D

SR-24-250B

Y-53-200

Y-60-275

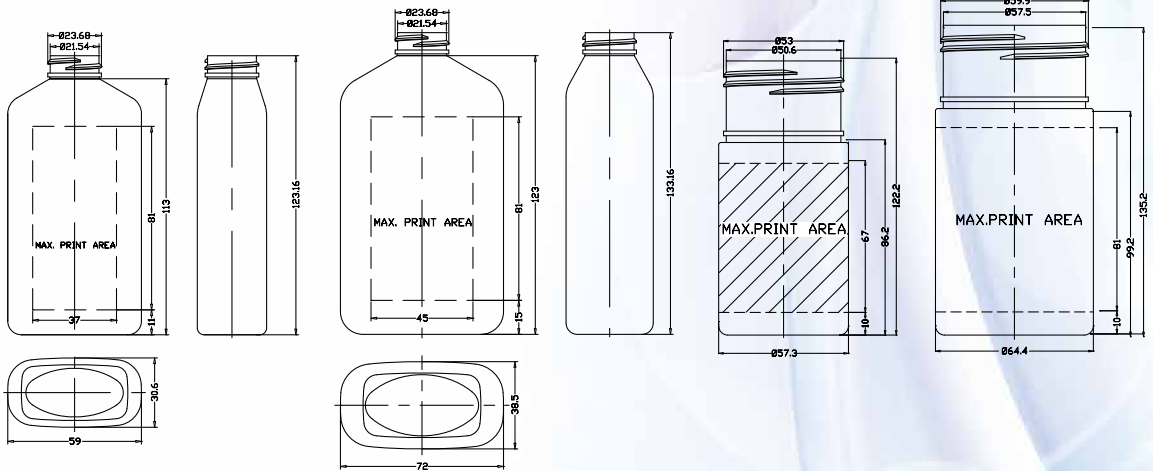

**SR-24-150D**

满口水容量(O.F.C.): 160ml

**SR-24-250B**

满口水容量(O.F.C.): 273ml

**Y-53-200**

满口水容量(O.F.C.): 266ml

**Y-60-275**

满口水容量(O.F.C.): 368ml





SR-24-350A

SR-33-750

SR-24-350B

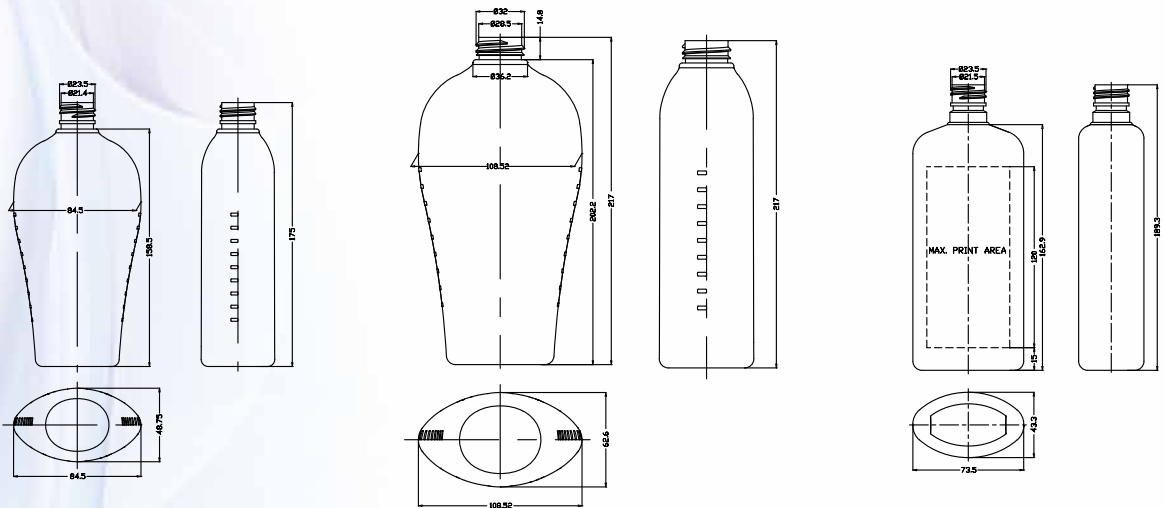

**SR-24-350A**

满口水容量(O.F.C.): 390ml

**SR-33-750**

满口水容量(O.F.C.): 805ml

**SR-24-350B**

满口水容量(O.F.C.): 369ml



SR-15-25

SR-18-35

SR-20-110

SR-20-100

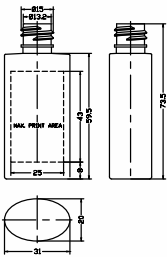

**SR-15-25**

满口水容量(O.F.C.): 26ml

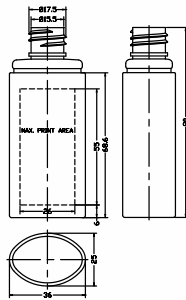

**SR-18-35**

满口水容量(O.F.C.): 44ml

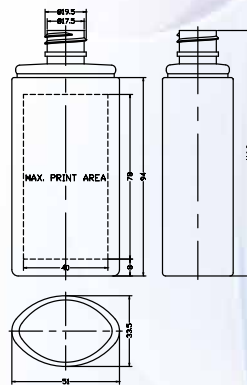

**SR-20-110**

满口水容量(O.F.C.): 120ml

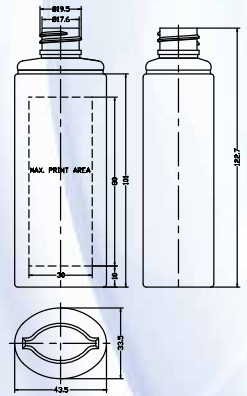

**SR-20-100**

满口水容量(O.F.C.): 112ml

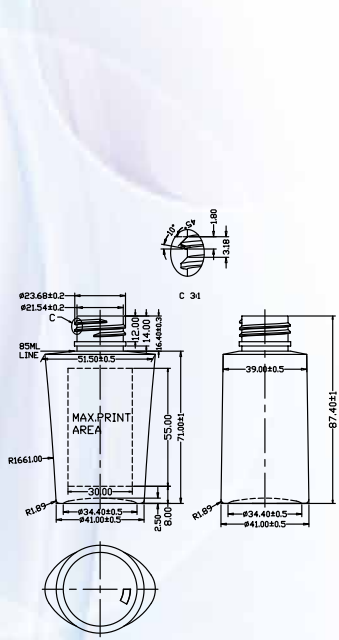

**T-24-80**  
满口水容量(O.F.C.): 90ml

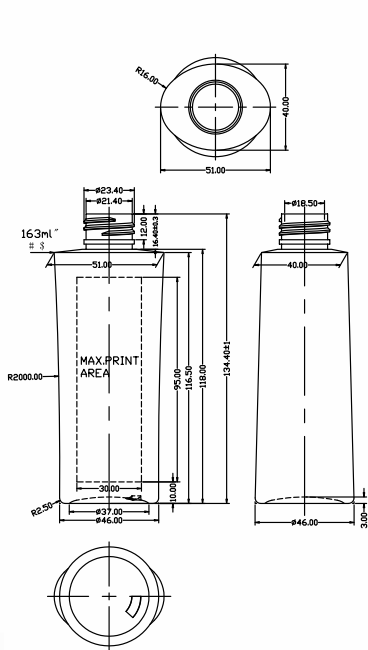

**T-24-150**  
满口水容量(O.F.C.): 169ml

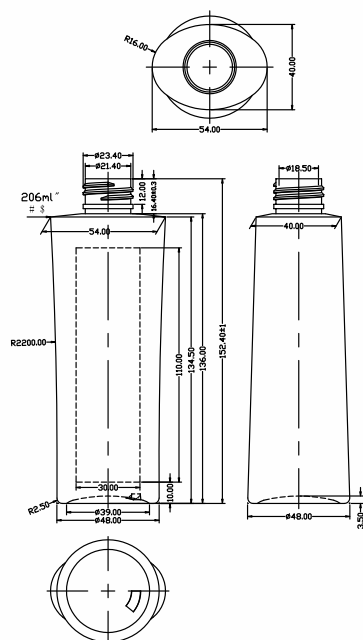

**T-24-200B**  
满口水容量(O.F.C.): 213ml



B-28-500

B-24-300

B-20-150

TP-20-80

TP-24-250

TP-28-500

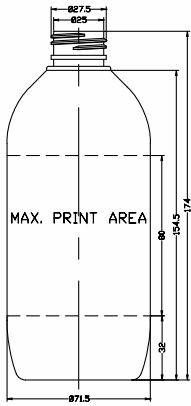

**B-28-500**

满口水容量(O.F.C.): 551ml

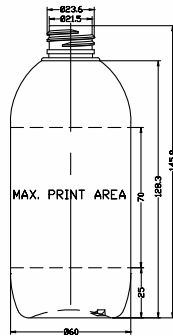

**B-24-300**

满口水容量(O.F.C.): 315ml

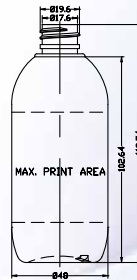

**B-20-150**

满口水容量(O.F.C.): 163ml

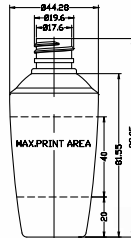

**TP-20-80**

满口水容量(O.F.C.): 90ml

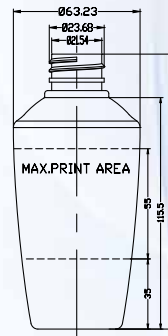

**TP-24-250**

满口水容量(O.F.C.): 265ml

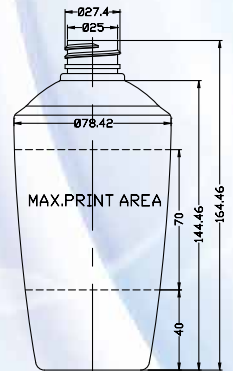

**TP-28-500**

满口水容量(O.F.C.): 520ml



Y-20-300S

Y-20-250S

Y-20-200S

ZB-18-10B

Y-28-50

Y-33-120B



**Y-20-300S**

满口水容量(O.F.C.): 323ml

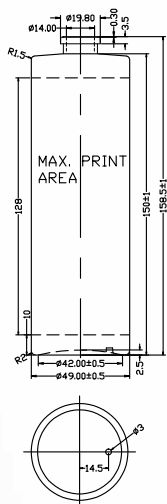

**Y-20-250S**

满口水容量(O.F.C.): 263ml

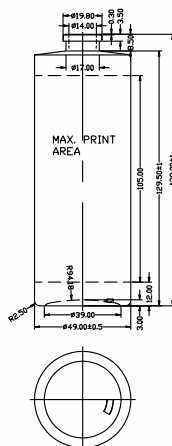

**Y-20-200S**

满口水容量(O.F.C.): 219ml

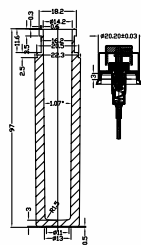

**ZB-18-10B**

满口水容量(O.F.C.): 13ml

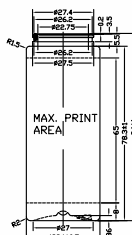

**Y-28-50**

满口水容量(O.F.C.): 57ml

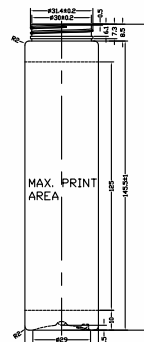

**Y-33-120B**

满口水容量(O.F.C.): 135ml



Y-20-50A



Y-20-60C



Y-24-100



Y-24-100C



Y-20-120



Y-24-80



Y-24-180



Y-22-100



Y-24-30A



Y-18-30



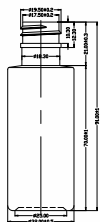

**Y-20-50A**

满口水容量(O.F.C.): 51ml

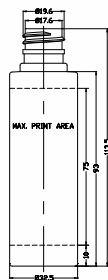

**Y-20-60C**

满口水容量(O.F.C.): 70ml

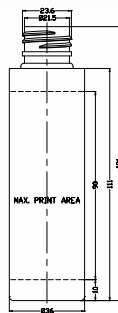

**Y-24-100**

满口水容量(O.F.C.): 106ml

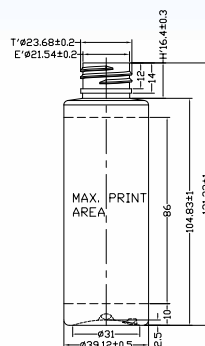

**Y-24-100C**

满口水容量(O.F.C.): 116ml

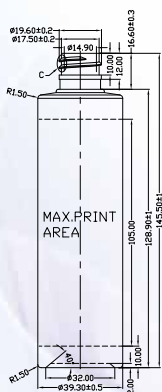

**Y-20-120**

满口水容量(O.F.C.): 140ml

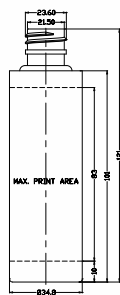

**Y-24-80**

满口水容量(O.F.C.): 84ml

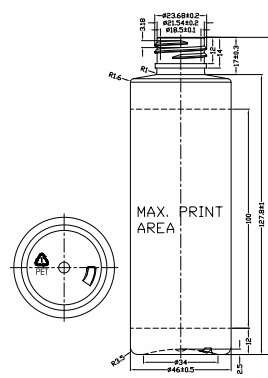

**Y-24-180**

满口水容量(O.F.C.): 200ml

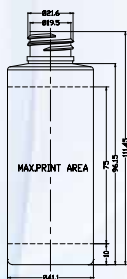

**Y-22-100**

满口水容量(O.F.C.): 112ml

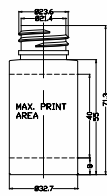

**Y-24-30A**

满口水容量(O.F.C.): 43ml

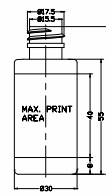

**Y-18-30**

满口水容量(O.F.C.): 35ml



YP-24-120A

YP-24-120B

YP-24-150

YP-24-200

YP-24-250

YP-24-300

Y-24-350

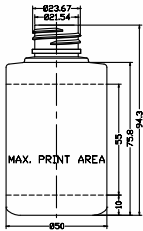

**YP-24-120A**

满口水容量(O.F.C.): 135ml

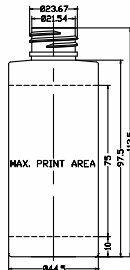

**YP-24-120B**

满口水容量(O.F.C.): 137ml



**YP-24-150**

满口水容量(O.F.C.): 164ml

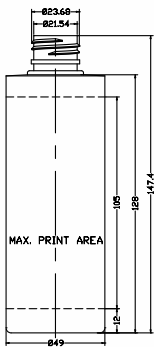

**YP-24-200**

满口水容量(O.F.C.): 223ml

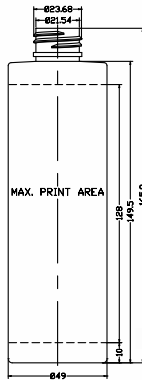

**YP-24-250**

满口水容量(O.F.C.): 263ml

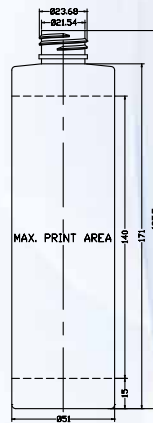

**YP-24-300**

满口水容量(O.F.C.): 330ml

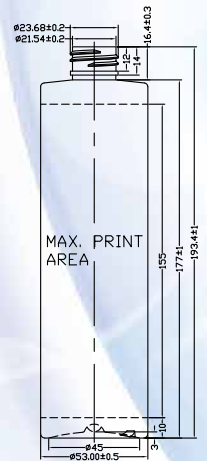

**Y-24-350**

满口水容量(O.F.C.): 365ml



YP-24-120A

Y-24-170

YP-24-200

YP-24-150

YP-24-120B

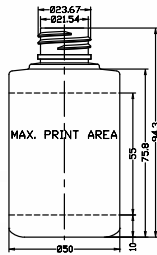

**YP-24-120A**

满口水容量(O.F.C.): 135ml

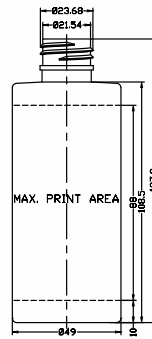

**Y-24-170**

满口水容量(O.F.C.): 191ml

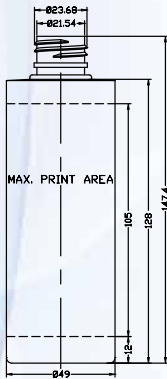

**YP-24-200**

满口水容量(O.F.C.): 223ml

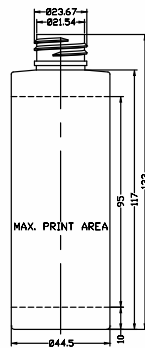

**YP-24-150**

满口水容量(O.F.C.): 164ml

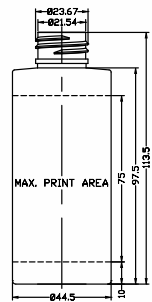

**YP-24-120B**

满口水容量(O.F.C.): 137ml



Y-20-40

Y-20-60

Y-24-150A

Y-24-120B

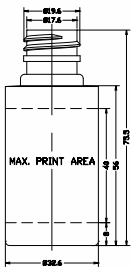

**Y-20-40**

满口水容量(O.F.C.): 45ml

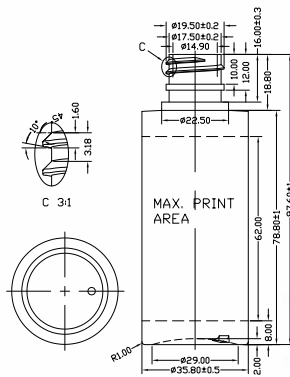

**Y-20-60**

满口水容量(O.F.C.): 72ml

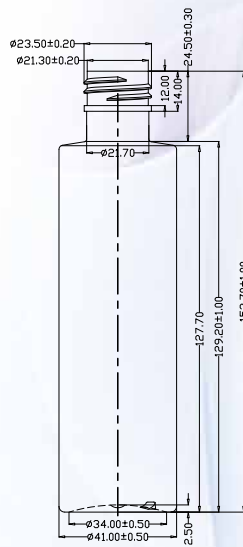

**Y-24-150A**

满口水容量(O.F.C.): 156ml

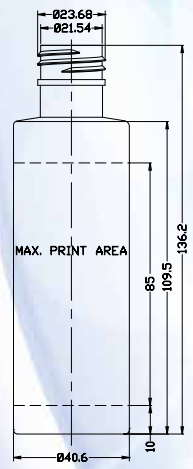

**Y-24-120B**

满口水容量(O.F.C.): 129ml



Y-24-150

Y-24-120C

Y-20-60C

Y-20-50

Y-24-60D

Y-24-120A

Y-20-30B

Y-20-25B

Y-20-15

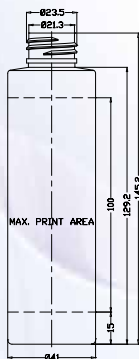

**Y-24-150**

满口水容量(O.F.C.): 156ml

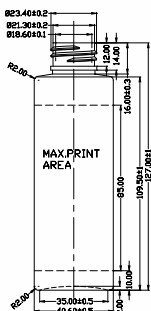

**Y-24-120C**

满口水容量(O.F.C.): 129ml

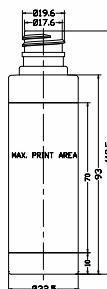

**Y-20-60C**

满口水容量(O.F.C.): 70ml

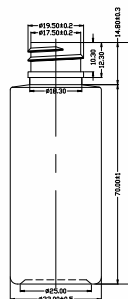

**Y-20-50**

满口水容量(O.F.C.): 50ml



**Y-24-60D**

满口水容量(O.F.C.): 74ml

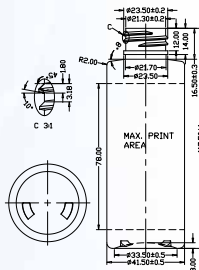

**Y-24-120A**

满口水容量(O.F.C.): 129ml

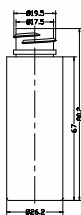

**Y-20-30B**

满口水容量(O.F.C.): 40ml

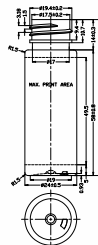

**Y-20-25B**

满口水容量(O.F.C.): 25ml

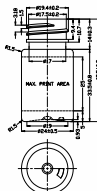

**Y-20-15**

满口水容量(O.F.C.): 15ml

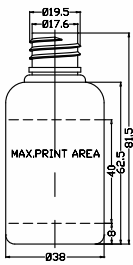

**B-20-60A**

满口水容量(O.F.C.): 67ml

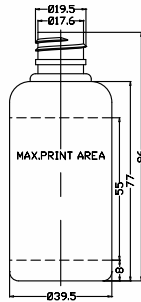

**B-20-80**

满口水容量(O.F.C.): 87ml

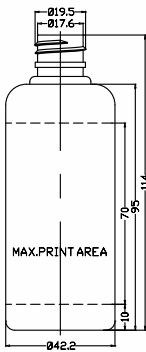

**B-20-100A**

满口水容量(O.F.C.): 124ml

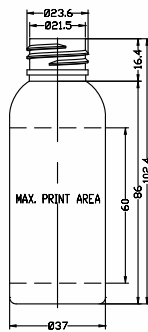

**B-24-80**

满口水容量(O.F.C.): 85ml

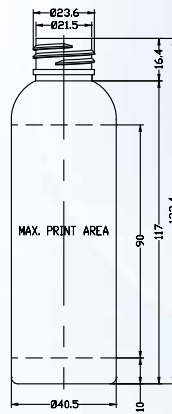

**B-24-120**

满口水容量(O.F.C.): 137ml

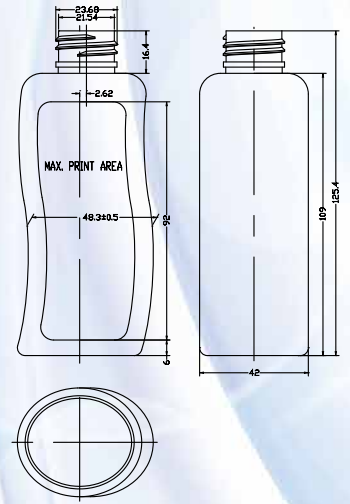

**SR-24-150**

满口水容量(O.F.C.): 157ml



B-20-110

B-20-125

B-24-200

B-24-220

B-24-210

B-24-250



**B-20-110**

满口水容量(O.F.C.): 112ml

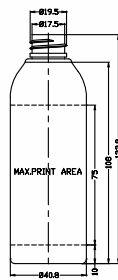

**B-20-125**

满口水容量(O.F.C.): 129ml

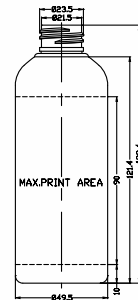

**B-24-200**

满口水容量(O.F.C.): 217ml

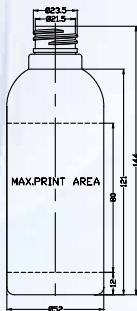

**B-24-220**

满口水容量(O.F.C.): 232ml

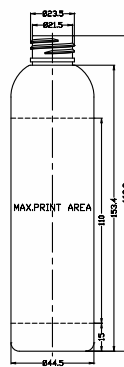

**B-24-210**

满口水容量(O.F.C.): 222ml

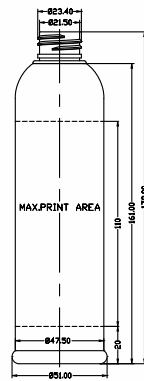

**B-24-250**

满口水容量(O.F.C.): 257ml



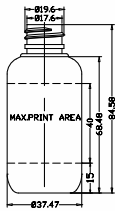

**B-20-60**

满口水容量(O.F.C.): 65ml

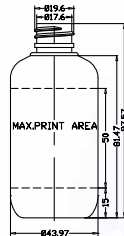

**B-20-100B**

满口水容量(O.F.C.): 108ml

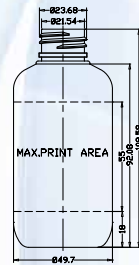

**B-24-150A**

满口水容量(O.F.C.): 160ml

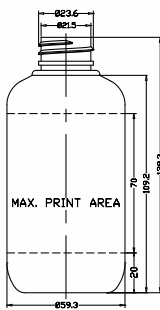

**B-24-250A**

满口水容量(O.F.C.): 276ml

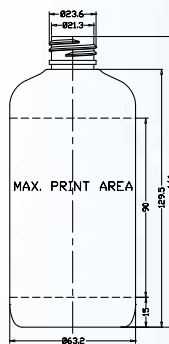

**B-24-350**

满口水容量(O.F.C.): 368ml

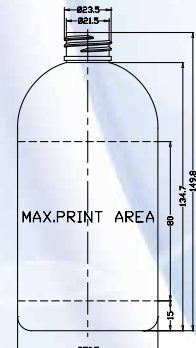

**B-24-450**

满口水容量(O.F.C.): 465ml



B-24-150B

B-28-250B

B-28-500C

Z-24-330

Z-28-550

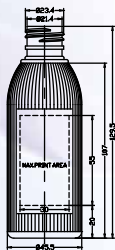

**B-24-150B**

满口水容量(O.F.C.): 158ml

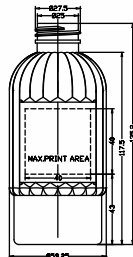

**B-28-250B**

满口水容量(O.F.C.): 280ml

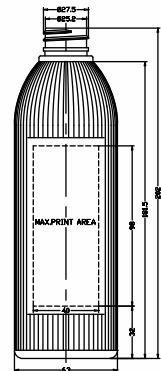

**B-28-500C**

满口水容量(O.F.C.): 514ml

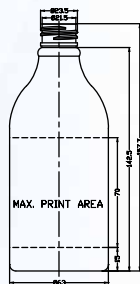

**Z-24-330**

满口水容量(O.F.C.): 355ml

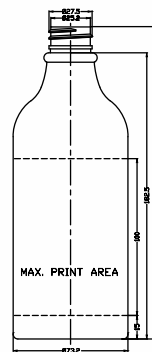

**Z-28-550**

满口水容量(O.F.C.): 626ml





T-18-50

T-20-80

T-20-100A

T-20-120

T-24-160

T-24-200A

T-28-350

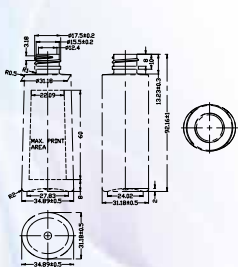

**T-18-50**

满口水容量(O.F.C.): 59ml

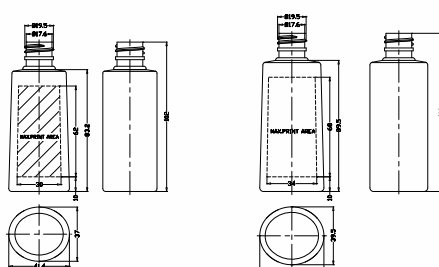

**T-20-80**

满口水容量(O.F.C.): 87ml

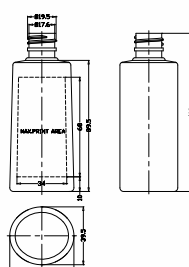

**T-20-100A**

满口水容量(O.F.C.): 107ml

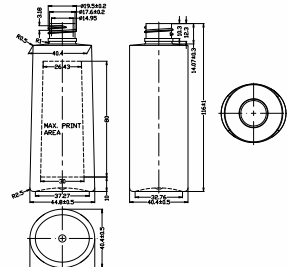

**T-20-120**

满口水容量(O.F.C.): 127ml

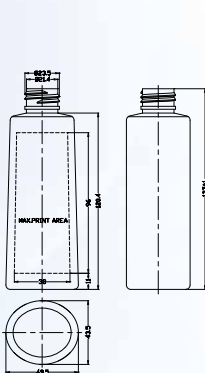

**T-24-160**

满口水容量(O.F.C.): 171ml

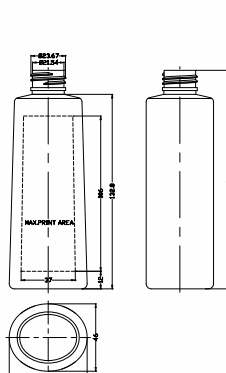

**T-24-200A**

满口水容量(O.F.C.): 222ml

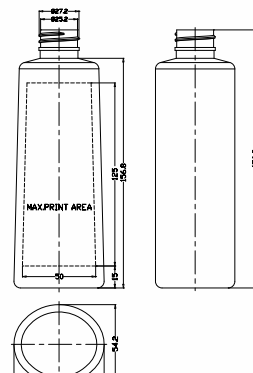

**T-28-350**

满口水容量(O.F.C.): 363ml



C-20-40

C-20-80

C-24-120

SR-24-140

SR-24-195

SR-28-300

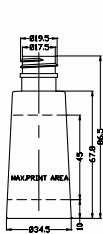

**C-20-40**

满口水容量(O.F.C.): 48ml

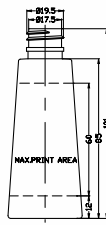

**C-20-80**

满口水容量(O.F.C.): 88ml

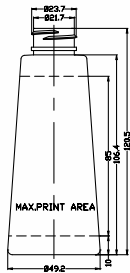

**C-24-120**

满口水容量(O.F.C.): 134ml

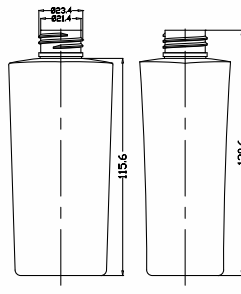

**SR-24-140**

满口水容量(O.F.C.): 157ml

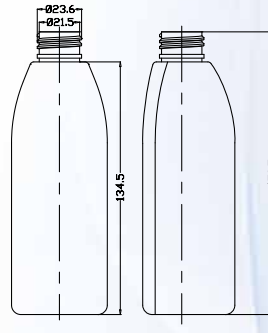
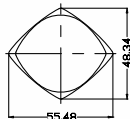

**SR-24-195**

满口水容量(O.F.C.): 205ml

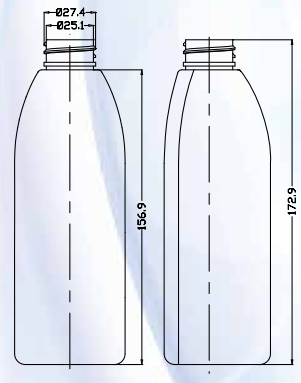
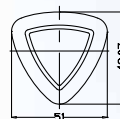

**SR-28-300**

满口水容量(O.F.C.): 323ml

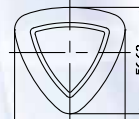



YX-24-120

YX-24-150

YX-24-110

YX-20-135

YX-24-250

YX-28-350

YX-28-450

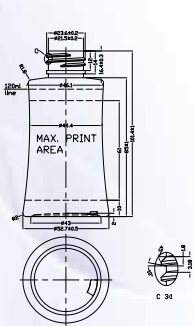

**YX-24-120**

满口水容量(O.F.C.): 135ml

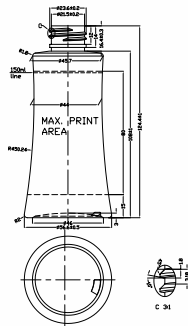

**YX-24-150**

满口水容量(O.F.C.): 174ml

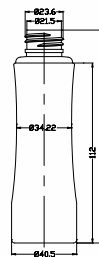

**YX-24-110**

满口水容量(O.F.C.): 111ml

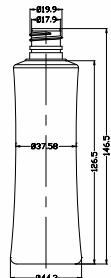

**YX-20-135**

满口水容量(O.F.C.): 140ml

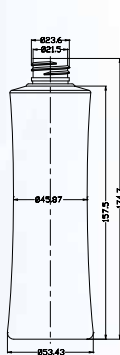

**YX-24-250**

满口水容量(O.F.C.): 270ml

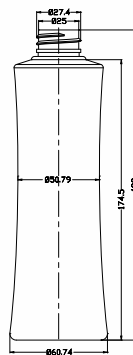

**YX-28-350**

满口水容量(O.F.C.): 367ml

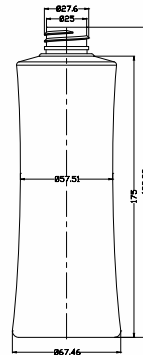

**YX-28-450**

满口水容量(O.F.C.): 467ml





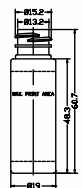

**Y-16-10**

满口水容量(O.F.C.): 10ml

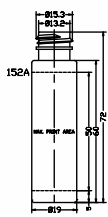

**Y-16-15**

满口水容量(O.F.C.): 15ml

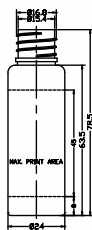

**Y-18-25**

满口水容量(O.F.C.): 27ml

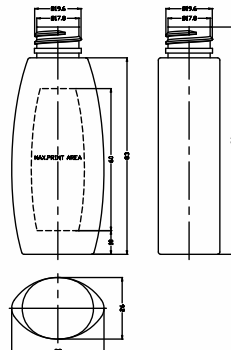

**T-20-50**

满口水容量(O.F.C.): 70ml

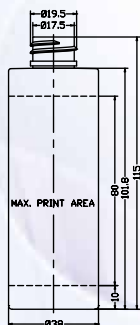

**Y-20-100**

满口水容量(O.F.C.): 106ml

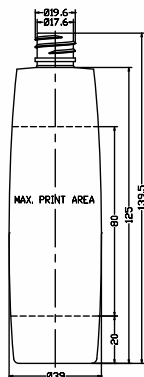

**Q-20-120**

满口水容量(O.F.C.): 125ml

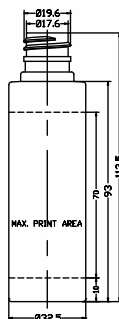

**Y-20-60C**

满口水容量(O.F.C.): 70ml

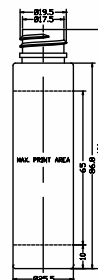

**Y-20-40D**

满口水容量(O.F.C.): 40ml



**Y-20-25**

满口水容量(O.F.C.): 29ml

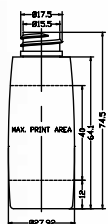

**Q-18-30**

满口水容量(O.F.C.): 30ml

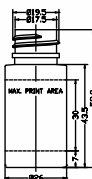

**Y-20-20**

满口水容量(O.F.C.): 22ml

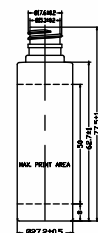

**Y-18-30A**

满口水容量(O.F.C.): 34ml



SR-20-60B

SR-20-80

SR-24-150C

SR-20-100B

SR-20-50

SR-20-67

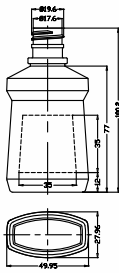

**SR-20-60B**

满口水容量(O.F.C.): 66ml

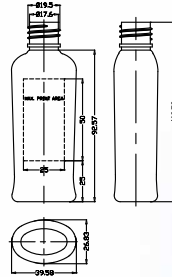

**SR-20-80**

满口水容量(O.F.C.): 85ml

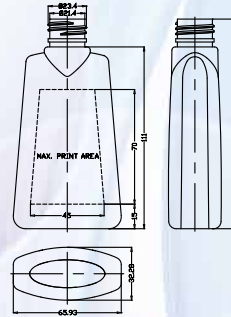

**SR-24-150C**

满口水容量(O.F.C.): 151ml

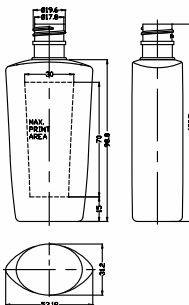

**SR-20-100B**

满口水容量(O.F.C.): 110ml

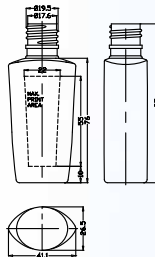

**SR-20-50**

满口水容量(O.F.C.): 54ml

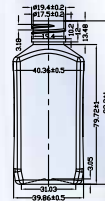

**SR-20-67**

满口水容量(O.F.C.): 71ml

## High quality foaming pump 高品质的泡沫泵



1. WP30-300 output is 0.4CC.  
WP30-300的泵出量是0.4CC。
2. All 43mm and 40mm foam pump output is 0.7CC.  
所有43和40mm 牙径的泡沫泵，泵出量都是0.7CC。
3. PP and K resin over cap available for your choice.  
防尘罩可以选择PP或K料。
4. SUS-304 spring.  
采用进口SUS-304弹簧。



## Fine mist sprayer 喷雾泵



1. 0.19CC Output, suitable for hair gel product.  
所有喷雾泵的喷出量是0.19CC, 适宜头发类产品使用。
2. PP and K resin over cap available for your choice.  
防尘罩可以选择PP或K料。
3. SUS-304 spring.  
采用进口SUS-304弹簧。

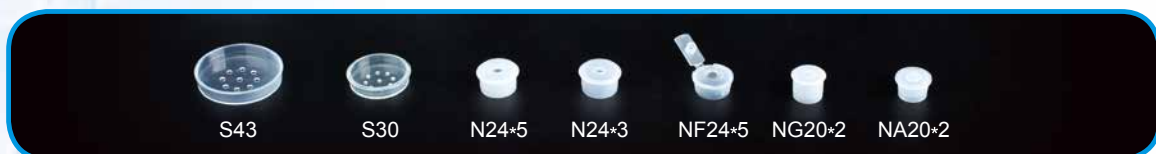
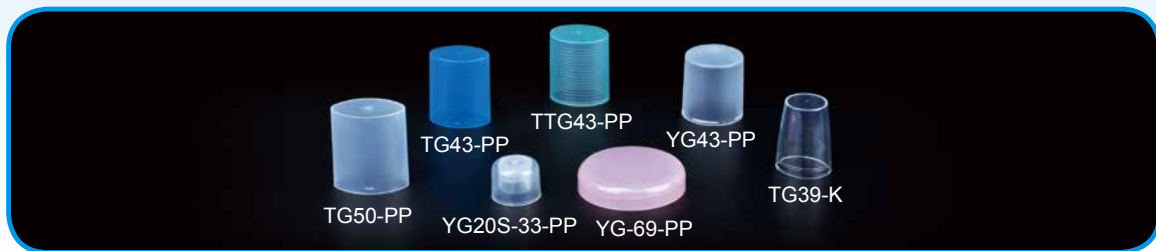



### Specifications list of stock PET preform PET胚管规格列表

Neck size 螺牙规格	Weight(g) 重量	Length(mm) 长度	Neck size 螺牙规格	Weight(g) 重量	Length(mm) 长度	Neck size 螺牙规格	Weight(g) 重量	Length(mm) 长度	
15mm	5	52	28/410	12	62.5	40mm	25	75	
	11	74		14	75		30	85	
18/410 18/415	4.5	43		16	65		33	86.35	
	6.5	51		19	90		37	92	
	8	62		22	83		62	150	
	11	75		25	85	43mm	25	83	
	12	63		29	108		27	90	
17	93.42	32		105	40		115		
20/410 20/415	6	50		35	130	70	148		
	8	60		39	135	48mm	12	38	
	10	70		45	135	53mm	45	105	
	11	74		54	150	60mm	60	115	
	13	74		30/400	12	60	70mm	15	22
	15	90			16	79		18	38
	18	98.5	20		77	20		45	
	19	100	25		80	23		42	
	21	102	33mm	12	52	25		60	
	23	100		26	96	35		45	
30	123	30		100	82mm	35	57		
22/410	22	100		34	95	89mm	23	28	
22/415	26	105		39	125		30	38	
24/400 24/410 24/415	8	50		44	131		35	42	
	12	70		46	138		45	48	
	15	83.5		51	138		65	90	
	16	100		55	153	87	110		
	19	97		60	153	100mm	38	33	
	22	97	65	153	106mm	36	35		
	25	106.5	75	170					
	30	121.5	80	160					
	35	136							
	40	133							

# WELLPAC

优邦包装

# MAIN CLIENTS

主要客户

L'ORÉAL



PAULA'S  
CHOICE



nutrimetics

OLEHENRIKSEN



LANGÉ  
PARIS

HATCHBEAUTY



GATSBY

JOSIE MARAN

Wild Ferns

ECOYA

nudebynature



trilogy



WELLPAC

优邦包装

MAIN CLIENTS

主要客户



RODAN+FIELDS

H2O+ BEAUTY



ESPA

Elizabeth Arden

PROVAMED



Margaret Dabbs LONDON



BLOODY KNUCKLES



BTZ BEYOND THE ZONE

Too Faced



GENTS of LONDON

BEAUTYBIO

